

# Optional probes and LH-600 calibration block

**12AAF666**  
Ball probe  $\varnothing$  1 mm

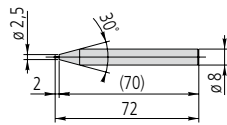

**12AAF670**  
Disk probe  $\varnothing$  5 mm

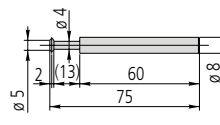

**12AAC072** Depth measurement probe

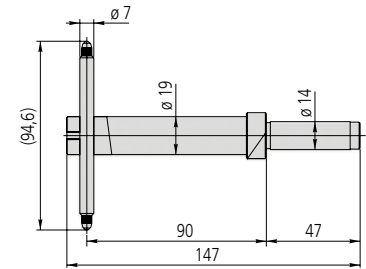

**957261**  
Ball probe  $\varnothing$  2 mm

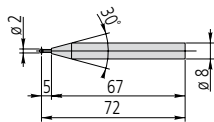

**12AAF671**  
Disk probe  $\varnothing$  10 mm

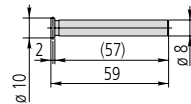

**12AAF667**  
Ruby ball probe  
 $\varnothing$  2 mm

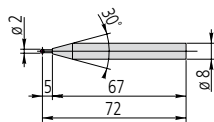
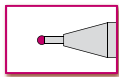

**957264**  
Disk probe  $\varnothing$  14 mm

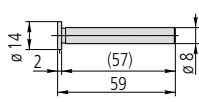

**12AAC073** Tapered probe  $\varnothing$  20 mm

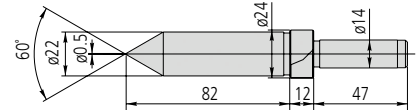

**957262**  
Ball probe  $\varnothing$  3 mm

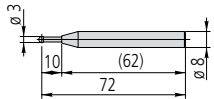

**957265**  
Disk probe  $\varnothing$  20 mm

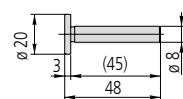

**957263**  
Ball probe  $\varnothing$  4 mm

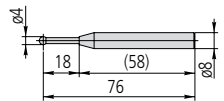

**12AAF672**  
Ball offset probe\*  
 $\varnothing$  1 mm  
\*Lever gage probe tip (103017)

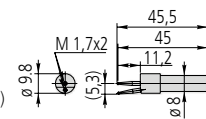

**12AAA792** Gage holder ( $\varnothing$  8 mm shaft)

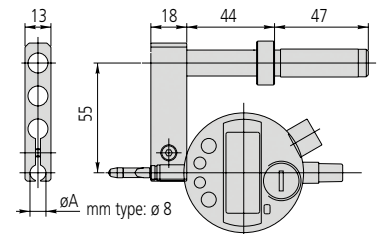

**12AAB552**  
Ball probe, L=55  
 $\varnothing$  10 mm

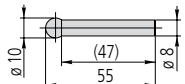

**12AAF673**  
Ball offset probe  
 $\varnothing$  2 mm

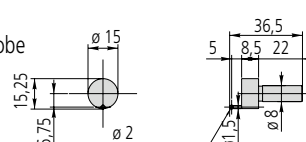

**12AAF668**  
Ball probe, L=82  $\varnothing$  10 mm

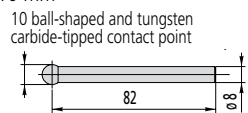

**12AAA788**  
Ball offset probe  
 $\varnothing$  4 mm

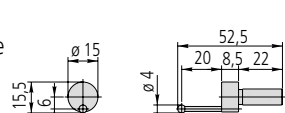

**12AAA793** Probe extension holder (85 mm)

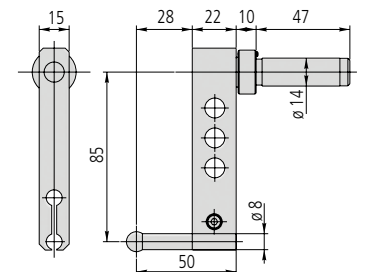

**12AAF669**  
Ball probe, L=120  $\varnothing$  10 mm

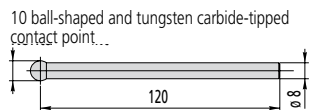

**12AAA789**  
Ball offset probe  
 $\varnothing$  6 mm

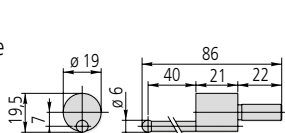

**226116**  
Adapter for mounting probes  
with  $\varnothing$  6 mm shaft

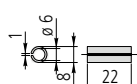

**226117**  
Adapter for CMM  
probe with M2 thread

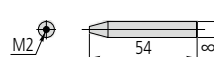

**932361** Holder for M $\mu$  checker

**226118**  
Adapter for CMM  
probe with M3 thread

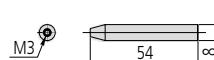

**12AAB136**  $\varnothing$  10 mm cylindrical probe  
with mount

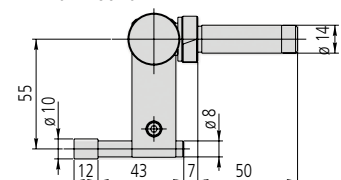

**12AAA787** Calibration block for probe diameters  
(also suitable for tapered probes)