

PUSH-BUTTON TEMPERATURE TRANSMITTER

Programmable, RTD, Thermistor or Thermocouple Input, In-Head Mounting

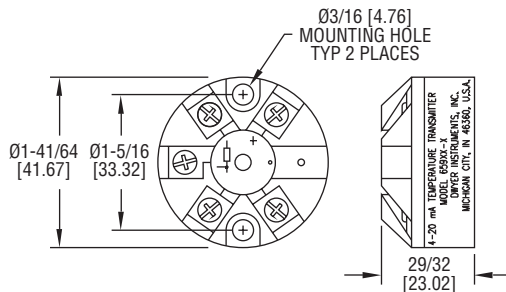

The **SERIES 659** Push-Button Temperature Transmitters accept thermocouple (J, K, T), RTD (Pt100 Ω) or thermistor input and provide a linearized 4 to 20 mA output. The transmitter is quickly ranged and calibrated by using a single on-board switch.

FEATURES/BENEFITS

- Push button calibration adjustment
- Reverse polarity protection
- Standard temperature sensor head enclosure mounting
- Sensor fault LED

APPLICATIONS

- Process applications where a 4 to 20 mA signal is required

| MODEL CHART | |
|-------------|-----------------------------|
| Model | Input |
| 659TC-1 | Thermocouple (Type J, K, T) |
| 659RTD-1 | 3-wire (RTD Pt100) |
| 659TH-1 | Thermistor (2252 Ω) |

SPECIFICATIONS

Input Range: Type J T/C: -328 to 2192°F (-200 to 1200°C); Type K T/C: -328 to 2498°F (-200 to 1370°C); Type T T/C: -328 to 752°F (-200 to 400°C); Pt100 Ω RTD: -328 to 1562°F (-200 to 850°C); Thermistor: -13 to 257°F.

Accuracy: T/C models: $\pm 0.04\%$ FS., $\pm 0.04\%$ of reading or $\pm 0.5^\circ\text{C}$ whichever is greater; RTD: $\pm 0.2^\circ\text{C} \pm 0.1\%$ of rdg; Thermistor: $\pm 0.25^\circ\text{F}$ ($\pm 0.1^\circ\text{C}$).

Output: Linearized 4 to 20 mA, 2-wire loop powered.

Sample Rate: 500 ms.

Loop Resistance: T/C: 700 Ω @ 24 VDC; RTD: 800 Ω @ 24 VDC; Thermistor: 24 VDC.

Output Thermal Drift: Zero: 0.2 $\mu\text{A}/^\circ\text{C}$; Span: 0.5 $\mu\text{A}/^\circ\text{C}$.

Temperature Limits: Ambient: -4 to 158°F (-20 to 70°C), 80% RH max.

Ambient Storage Temperature: -40 to 158°F (-40 to 70°C), 95% RH max.

Burnout: Upscale 22 mA.

Weight: 0.92 oz (26 g).

Agency Approvals: CE.