

CURRENT TRANSFORMERS

SPLIT CORE CURRENT TRANSFORMERS

MODEL FCL

SPECIFICATIONS: 5 AMP SECONDARY MODELS

CURRENT RATIO	INSIDE DIAMETER						BURDEN CAPACITY	ACCURACY	
	ROUND				RECTANGLE				
	4"	6"	8"	11"	18"	-R			-R411
200/5	X	-	-	-	-	-	-	2VA	4%
250/5	X	-	-	-	-	-	-	2VA	4%
300/5	X	X	-	-	-	-	-	2VA	4%
400/5	X	X	-	-	-	X	-	2VA	3%
500/5	X	X	-	-	-	X	-	3VA	3%
600/5	X	X	-	-	-	X	-	5VA	2%
800/5	X	X	-	-	-	X	-	5VA	2%
1000/5	X	X	X	-	-	X	-	5VA	1%
1200/5	X	X	X	-	-	X	-	5VA	1%
1500/5	X	X	X	X	-	X	X	15VA	1%
1600/5	X	X	X	X	-	X	X	15VA	1%
2000/5	X	X	X	X	X	X	X	25VA	1%
2400/5	-	X	X	X	X	X	X	30VA	1%
2500/5	-	X	X	X	X	X	X	35VA	1%
3000/5	-	X	X	X	X	X	X	45VA	1%
3500/5	-	X	X	X	X	X	X	45VA	1%
4000/5	-	X	X	X	X	X	X	45VA	1%
5000/5	-	-	X	X	X	-	X	45VA	1%
6000/5	-	-	-	X	X	-	X	45VA	1%

AVERAGE WEIGHT	4"	6"	8"	11"	18"	(R) 2 3/4"x6 5/8"	(R411) 4"x11"
	4.00 Lbs.	6.00 Lbs.	7.00 Lbs.	9.00 Lbs.	17 Lbs.	6.00 Lbs.	8.00 Lbs.

SPECIFICATIONS: 1 AMP SECONDARY MODELS

CURRENT RATIO	INSIDE DIAMETER						BURDEN (Ω)	ACCURACY	
	ROUND				RECTANGLE				
	4"	6"	8"	11"	18"	-R			-R411
200/1	X	-	-	-	-	-	-	0.5	1%
250/1	X	-	-	-	-	-	-	0.5	1%
300/1	X	-	-	-	-	-	-	0.5	1%
400/1	X	-	-	-	-	-	-	0.9	1%
500/1	X	X	-	-	-	X	-	2.0	1%
600/1	X	X	-	-	-	X	-	3.0	1%
800/1	X	X	-	-	-	X	-	5.0	1%
1000/1	X	X	X	-	-	X	X	10.0	1%
1200/1	-	X	X	-	-	X	X	15.0	1%
1500/1	-	X	X	X	-	X	X	15.0	1%
1600/1	-	X	X	X	-	X	X	15.0	1%
2000/1	-	X	X	X	X	-	X	18.0	1%
2400/1	-	-	X	X	X	-	X	20.0	1%
2500/1	-	-	X	X	X	-	X	20.0	1%
3000/1	-	-	-	X	X	-	-	20.0	1%

AVERAGE WEIGHT	4"	6"	8"	11"	18"	(R) 2 3/4"x6 5/8"	(R411) 4"x11"
	5.00 Lbs.	7.00 Lbs.	8.00 Lbs.	9.50 Lbs.	18 Lbs.	7.00 Lbs.	8.50 Lbs.

CURRENT TRANSFORMERS

SPLIT CORE CURRENT TRANSFORMERS

MODEL FCL

SPECIFICATIONS: 1.0 VOLT SECONDARY MODELS

CURRENT RATIO	INSIDE DIAMETER						ACCURACY	
	ROUND					RECTANGLE		
	4"	6"	8"	11"	18"	-R		-R411
200/1Vac	X	-	-	-	-	-	-	1%
250/1Vac	X	-	-	-	-	-	-	1%
300/1Vac	X	-	-	-	-	-	-	1%
400/1Vac	X	-	-	-	-	-	-	1%
500/1Vac	X	X	-	-	-	X	-	1%
600/1Vac	X	X	-	-	-	X	-	1%
800/1Vac	X	X	-	-	-	X	-	1%
1000/1Vac	X	X	X	-	-	X	X	1%
1200/1Vac	-	X	X	-	-	X	X	1%
1500/1Vac	-	X	X	X	-	X	X	1%
1600/1Vac	-	X	X	X	-	X	X	1%
2000/1Vac	-	X	X	X	X	-	X	1%
2400/1Vac	-	-	-	X	X	-	X	1%
2500/1Vac	-	-	-	X	X	-	X	1%
3000/1Vac	-	-	-	X	X	-	-	1%

AVERAGE	4"	6"	8"	11"	18"	(R) 2 3/4"x6 5/8"	(R411) 4"x11"
WEIGHT	5.00 Lbs.	7.00 Lbs.	8.00 Lbs.	9.00 Lbs.	18 Lbs.	7.00 Lbs.	8.50 Lbs.

SPECIFICATIONS: 0.333 VOLT SECONDARY MODELS

CURRENT RATIO	INSIDE DIAMETER						ACCURACY	
	ROUND					RECTANGLE		
	4"	6"	8"	11"	18"	-R		-R411
200/0.333Vac	X	-	-	-	-	-	-	1%
250/0.333Vac	X	-	-	-	-	-	-	1%
300/0.333Vac	X	-	-	-	-	-	-	1%
400/0.333Vac	X	-	-	-	-	-	-	1%
500/0.333Vac	X	X	-	-	-	X	-	1%
600/0.333Vac	X	X	-	-	-	X	-	1%
800/0.333Vac	X	X	-	-	-	X	-	1%
1000/0.333Vac	X	X	X	-	-	X	X	1%
1200/0.333Vac	X	X	X	-	-	X	X	1%
1500/0.333Vac	X	X	X	X	-	X	X	1%
1600/0.333Vac	X	X	X	X	X	X	X	1%
2000/0.333Vac	-	X	X	X	X	X	X	1%
2400/0.333Vac	-	X	X	X	X	X	X	1%
2500/0.333Vac	-	X	X	X	X	X	X	1%
3000/0.333Vac	-	X	X	X	X	X	X	1%
3500/0.333Vac	-	X	X	X	X	X	X	1%
4000/0.333Vac	-	X	X	X	X	X	X	1%
5000/0.333Vac	-	-	X	X	X	-	X	1%
6000/0.333Vac	-	-	X	X	X	-	X	1%

AVERAGE	4"	6"	8"	11"	18"	(R) 2 3/4"x6 5/8"	(R411) 4"x11"
WEIGHT	4.00 Lbs.	6.00 Lbs.	7.00 Lbs.	9.00 Lbs.	17 Lbs.	6.00 Lbs.	8.00 Lbs.

CURRENT TRANSFORMERS

SPLIT CORE CURRENT TRANSFORMERS MODEL FCL

DIMENSIONS

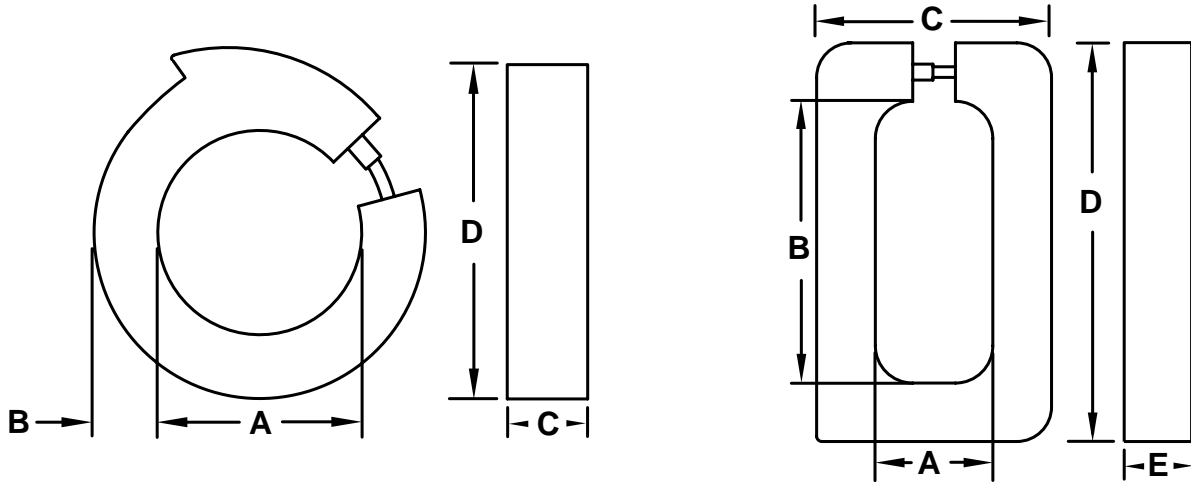

INSIDE DIAMETER	CIRCULAR			
A	B	C	D	MODEL
4	1 1/4	1 1/2	6 1/2	-4
6	1 1/4	1 1/2	8 1/2	-6
8	1 1/4	1 1/2	10 1/2	-8
11	1 1/4	1 1/2	13 1/2	-11
18	1 1/4	1 1/2	20 1/2	-18

INSIDE DIAMETER	RECTANGULAR				
A	B	C	D	E	MODEL
2 3/4	6 5/8	5 1/2	9 3/8	1 1/2	-R
4	11	6 1/2	13 3/8	1 1/2	-R411

All Dimensions In Inches
 Black Wire = X1
 White Wire = X2

CUSTOM INSERTS FOR FCL, FC CURRENT TRANSFORMERS

FEATURES

- Silicone rubber inserts (split, solid, customized)
- Custom cutouts to fit buss or cable sizes
- Designed to make installations easier
- Makes installation look cleaner
- Fits exact I.D. of 4", 6", 8", 11", 18", R, or R411 model FCL or FC Current Transformers
- May be used on indoor or *outdoor applications
 *Model FC only

SPECIFICATIONS

- Silicone rubber
- Offers added isolations of 575V/Mil insulation
- Remains Flexible from -45°C to +200°C
- Orange Color

